

## Application for road naming or renaming

### GENERAL INFORMATION

- Proposed names are to be submitted for **new roads in subdivisions** to Infrastructure & Asset Management Department with the application for resource consent.
- Proposed names are to be submitted (in writing) for **existing legal but unnamed roads**, to the Administration Officer, Infrastructure & Asset Management Department.
- Proposed road **renamings** are to be submitted in writing. Requests from outside of Council must provide information and background as to why the road should be renamed. Written consent from affected residents and owners must be obtained.
- The proposed names will be checked against Council's Roading database to avoid duplication.
- Liaise with the iwi when using Maori names and provide supporting document of their approval.
- Several names (3 are recommended) should be submitted for each road or accessway, in order of preference in case of rejection
- A background to the names, their origins and their link with the area is to be supplied
- Personal names are to be discouraged unless the name submitted has a historical connection with the property being subdivided, or are that of a well-known identity or prominent Far Northerner, or New Zealander
- It is Council's prerogative under Section 319(j) Local Government Act 1974 to name streets and the Council may refuse to approve names considered unsuitable
- Where more than one road is being created in a subdivision, a common theme is recommended for road names
- Private road names are considered by Council. They will need to meet Council's Signage Guidelines (white background with blue lettering).
- Names are to be chosen in proportion to the type of road, and in accordance with the Naming Guide at the end of the form
- If you are unsure if the road you want to name is a Council maintained road or private road, please contact the Infrastructure & Asset Management Department.

### APPLICANT DETAILS

Applicant/Developer Name: \_\_\_\_\_

Organisation: FNR PROPERTIES LTD.

Postal Address: North Road Kaitia

Phone: \_\_\_\_\_ Mobile: 021 711 383

Email: manu@fnr.nz.

**ROAD LOCATION**Address: 9 Whangatane Drive, Kaitia 0482Legal Description: Lot 3 DP 108190Resource Consent Application Number: 2200516

**Please supply a scheme plan map that clearly indicates the location of the Road, Private Road or Right-Of-Way when submitting your application.**

**TYPE OF ROAD (Please tick) -**

Public Road



Private Road



Right-of-Way

**PROPOSED ROAD NAMES**

<b>Road 1</b>	First Choice: <u>Te Paia Lane</u>
	Second Choice: <u>"</u>
	Third Choice: <u>"</u>
<b>Road 2</b>	First Choice:
	Second Choice:
	Third Choice:
<b>Road 3</b>	First Choice:
	Second Choice:
	Third Choice:

**BACKGROUND**

*A background to the names, their origins and their link with the area is to be supplied*

Named after one of the local  
Iwi Kaumatua.

## ROAD RENAMING

Please state the current road name and your reason for requesting the name change below then complete the rest of the form. Also, please ensure you attach the written consents of at least 85% of affected residents and attach to the application form.

## GENERAL INFORMATION AND GUIDELINES

Ensure that road names are not duplicated in the Far North District (*both spelling and pronunciation to be considered*); this includes same road names with different suffix. To do this, please use [www.google.co.nz/maps](http://www.google.co.nz/maps) and search "proposed road name (excl suffix) Northland" to check if proposed names may be duplicates.

Ensure that road type appropriately matches the definition of the suffix, such as 'road', 'avenue' etc. Road names without a suffix are now strongly discouraged (e.g. Broadway). The following definitions provide a guide, but please note that other appropriate suffixes that are not in this list may be used.

Suffix	Definition
--------	------------

Avenue	A generally broad straight roadway planted on each side with trees
Boulevard	A wide roadway well paved usually with trees and grass
Circle	A roadway that generally forms a circle or a short enclosed roadway bounded by a circle
Close	A short enclosed road.
Court	A short enclosed road usually surrounded by buildings
Crescent	A crescent or half-moon shaped street rejoining the road from which it starts
Drive	Wide main roadway without many cross streets - an especially scenic road or street
Esplanade	Level roadway along the seaside, lake or a river
Glade	Roadway usually in a valley of trees
Green	Roadway often leading to a grassed public recreation area
Grove	A road that often features a group of trees standing together
Lane	A narrow way, path, country road or street. A narrow passage between hedges or buildings, an alley
Loop	Roadway that diverges from and then rejoining a main thoroughfare
Mews	Roadway in a group of houses

Suffix	Definition
--------	------------

Parade	Public roadway or promenade
Place	A short sometimes narrow enclosed roadway
Quay	A roadway alongside or projecting into water
Rise	A roadway going to a higher place or position
Road	Route or way between places. General usage. Defined in Local Government Act 1974, Section 315
Terrace	Roadway on a hilly area that is mainly flat
Vale	A roadway along low ground between hills
Way	A winding or curved track or path for passing along



**The following are suitable suffixes for particular road types:**

**Road Type**

Cul-de-sac (*short dead-end street with turnaround at the end*)  
Wide spacious street

**Suffix**

Close, Court, Place  
Avenue, Boulevard, Parade

**The following are suitable suffixes for private roads and private ways categorised into particular road types:**

**Road Type**

Narrow road and right of way  
Associated with high ground  
Associated with low ground  
Tree lined road

**Suffix**

Lane, Way  
Rise,  
Vale  
Avenue, Glade, Grove

**Donaldsons Land Surveyors**  
**90 Kerikeri Road**  
**PO Box 211, Kerikeri**  
**New Zealand 0245**

Applicants Signature: \_\_\_\_\_

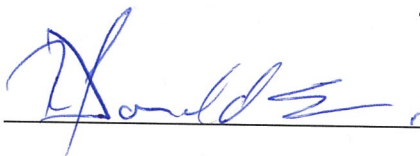

Date: \_\_\_\_\_

18/3/22

Return Application to Postal: Far North District Council  
Private Bag 752  
KAIKOHE 0440

or Email: [roadingalliance@fndc.govt.nz](mailto:roadingalliance@fndc.govt.nz)



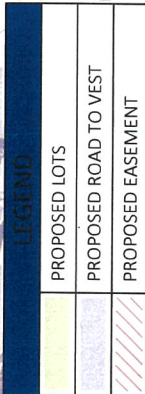

SCHEDULE OF PROPOSED EASEMENTS			
DESCRIPTION	SHOWN	SERVIENT TENEMENT	DOMINANT TENEMENT
RIGHT TO CONVEY SANITARY SEWER	(A)	LOT 1 HEREON	LOT 9 HEREON
	(D)	LOT 6 HEREON	LOT 5 HEREON
RIGHT TO CONVEY STORMWATER	(B)	LOT 8 HEREON	LOT 9 HEREON
	(C)	LOT 6 HEREON	LOT 9 HEREON
	(E)	LOT 6 HEREON	LOT 5 HEREON



**SUBDIVISION LAYOUT PLAN**

**FNR INDUSTRIAL SUBDIVISION**

Client:	<b>FNR GROUP LIMITED</b>
Location:	<b>170 FAR NORTH ROAD</b>
Project Name:	<b>FNR INDUSTRIAL SUB</b>
Drawn:	<b>C. FROST</b>



## Bob Donaldson

**From:** Bob Donaldson <bob@donaldsons.net.nz>  
**Sent:** Monday, 14 March 2022 1:20 PM  
**To:** 'Manu Burkhardt'  
**Subject:** RE: Subdivision

Manu  
Will do  
Bob

u u

ROAD NAMING



### DONALDSONS

Surveyors & Planners  
90 Kerikeri Road  
P.O.Box 211 Kerikeri  
New Zealand 0245  
Pho : (64) (9) 4079182  
[www.donaldsons.net.nz](http://www.donaldsons.net.nz)

---

**From:** Manu Burkhardt [<mailto:Manu@fnr.nz>]  
**Sent:** Monday, 14 March 2022 12:59 PM  
**To:** Bob Donaldson  
**Subject:** RE: Subdivision

Hi Bob,

The plan looks fine.  
We have satisfied 2a), 2b), 2c).

We have not done 2d), the street name application.  
How do we do this? Can you do it for us.

The street name proposed in the RC application was "Te Paia Lane", after one of the local Iwi Kaumatua.

Cheers

Manu

Manu Burkhardt-Macrae  
Managing Director

Mob 021 711 383 | [manu@fnr.nz](mailto:manu@fnr.nz)

North Road | Kaitaia | [www.fnrgroup.nz](http://www.fnrgroup.nz)





**RECORD OF TITLE  
UNDER LAND TRANSFER ACT 2017  
FREEHOLD  
Search Copy**



  
R.W. Muir  
Registrar-General  
of Land

**Identifier** **NA60C/270**  
**Land Registration District** **North Auckland**  
**Date Issued** 24 February 1986

**Prior References**  
NA5A/299

---

<b>Estate</b>	Fee Simple
<b>Area</b>	1.7745 hectares more or less
<b>Legal Description</b>	Lot 3 Deposited Plan 108190

**Registered Owners**  
FNR Properties Limited

---

**Interests**

C345446.1 Certificate pursuant to Transit New Zealand Act 1989 declaring that part No. 1 State Highway (Awanui-Bluff) to be a Limited Access Road - 10.2.1992 at 9:42 am  
11426345.1 Mortgage to ASB Bank Limited - 8.8.2019 at 1:43 pm  
11895911.1 CAVEAT BY TOP ENERGY LIMITED - 15.10.2020 at 4:47 pm

Agencies: ROAD SHOWN IS LEGAL

APPROVED: *[Signature]* REC'D TOWN

WARRANT TO A RESOLUTION OF THE KAITIA BOROUGH COUNCIL PASSED ON THE 24<sup>th</sup> DAY OF DECEMBER 1985 AUTHORIZING SURVEYOR J. S. HUNTIN TO ACTUALLY SURVEY THE LAND SHOWN TO THE CONDITIONS OF AMALGAMATION SET BY ACT 1985 AND CERTIFYING THAT THE SURVEY PLAN IS IN ACCORDANCE WITH THE REQUIREMENTS OF AMENDMENTS OF THE ACT. THE SURVEYOR HAS BEEN ADVISED THAT THE LAND IS NOT BEING USED FOR ANY OTHER PURPOSE AND THAT THE SURVEYOR HAS BEEN ADVISED THAT THE LAND IS NOT BEING USED FOR ANY OTHER PURPOSE AND THAT THE SURVEYOR HAS BEEN ADVISED THAT THE LAND IS NOT BEING USED FOR ANY OTHER PURPOSE.

THE COMMON SEAL OF THE KAITIA BOROUGH COUNCIL HAS BEEN AFFIXED IN THE PRESENCE OF:

*[Signature]* DEAN R. BOO AMMOR

*[Signature]* TOWN CLERK

THE COMMON SEAL OF THE KAITIA BOROUGH COUNCIL

AMALGAMATION COMMISSION

THAT LOT 1, HEREIN SET FORTH, TO THE WHOLE OF LOT 1, AS SHOWN (15.45/1987) AND THAT ONE CERTIFICATE OF TITLE BE ISSUED TO INCLUDE BOTH PARCELS SEE FILE A 626 287

Kaitia 1 & 1013

APPROVED AS TO CORRECTNESS OF LOT 1 AS SHOWN HEREIN (REAS) TO THE ACT 1985

NEW C.T. ALLOCATED -

LOT 1 605/1968

LOT 2 605/1969

LOT 3 605/1970

LOT 4 605/1971

LOT 5 605/1972

LOT 6 605/1973

LOT 7 605/1974

LOT 8 605/1975

LOT 9 605/1976

LOT 10 605/1977

LOT 11 605/1978

LOT 12 605/1979

LOT 13 605/1980

LOT 14 605/1981

LOT 15 605/1982

LOT 16 605/1983

LOT 17 605/1984

LOT 18 605/1985

LOT 19 605/1986

LOT 20 605/1987

LOT 21 605/1988

LOT 22 605/1989

LOT 23 605/1990

LOT 24 605/1991

LOT 25 605/1992

LOT 26 605/1993

LOT 27 605/1994

LOT 28 605/1995

LOT 29 605/1996

LOT 30 605/1997

LOT 31 605/1998

LOT 32 605/1999

LOT 33 605/2000

LOT 34 605/2001

LOT 35 605/2002

LOT 36 605/2003

LOT 37 605/2004

LOT 38 605/2005

LOT 39 605/2006

LOT 40 605/2007

LOT 41 605/2008

LOT 42 605/2009

LOT 43 605/2010

LOT 44 605/2011

LOT 45 605/2012

LOT 46 605/2013

LOT 47 605/2014

LOT 48 605/2015

LOT 49 605/2016

LOT 50 605/2017

LOT 51 605/2018

LOT 52 605/2019

LOT 53 605/2020

LOT 54 605/2021

LOT 55 605/2022

LOT 56 605/2023

LOT 57 605/2024

LOT 58 605/2025

LOT 59 605/2026

LOT 60 605/2027

LOT 61 605/2028

LOT 62 605/2029

LOT 63 605/2030

LOT 64 605/2031

LOT 65 605/2032

LOT 66 605/2033

LOT 67 605/2034

LOT 68 605/2035

LOT 69 605/2036

LOT 70 605/2037

LOT 71 605/2038

LOT 72 605/2039

LOT 73 605/2040

LOT 74 605/2041

LOT 75 605/2042

LOT 76 605/2043

LOT 77 605/2044

LOT 78 605/2045

LOT 79 605/2046

LOT 80 605/2047

LOT 81 605/2048

LOT 82 605/2049

LOT 83 605/2050

LOT 84 605/2051

LOT 85 605/2052

LOT 86 605/2053

LOT 87 605/2054

LOT 88 605/2055

LOT 89 605/2056

LOT 90 605/2057

LOT 91 605/2058

LOT 92 605/2059

LOT 93 605/2060

LOT 94 605/2061

LOT 95 605/2062

LOT 96 605/2063

LOT 97 605/2064

LOT 98 605/2065

LOT 99 605/2066

LOT 100 605/2067

LOT 101 605/2068

LOT 102 605/2069

LOT 103 605/2070

LOT 104 605/2071

LOT 105 605/2072

LOT 106 605/2073

LOT 107 605/2074

LOT 108 605/2075

LOT 109 605/2076

LOT 110 605/2077

LOT 111 605/2078

LOT 112 605/2079

LOT 113 605/2080

LOT 114 605/2081

LOT 115 605/2082

LOT 116 605/2083

LOT 117 605/2084

LOT 118 605/2085

LOT 119 605/2086

LOT 120 605/2087

LOT 121 605/2088

LOT 122 605/2089

LOT 123 605/2090

LOT 124 605/2091

LOT 125 605/2092

LOT 126 605/2093

LOT 127 605/2094

LOT 128 605/2095

LOT 129 605/2096

LOT 130 605/2097

LOT 131 605/2098

LOT 132 605/2099

LOT 133 605/2100

LOT 134 605/2101

LOT 135 605/2102

LOT 136 605/2103

LOT 137 605/2104

LOT 138 605/2105

LOT 139 605/2106

LOT 140 605/2107

LOT 141 605/2108

LOT 142 605/2109

LOT 143 605/2110

LOT 144 605/2111

LOT 145 605/2112

LOT 146 605/2113

LOT 147 605/2114

LOT 148 605/2115

LOT 149 605/2116

LOT 150 605/2117

LOT 151 605/2118

LOT 152 605/2119

LOT 153 605/2120

LOT 154 605/2121

LOT 155 605/2122

LOT 156 605/2123

LOT 157 605/2124

LOT 158 605/2125

LOT 159 605/2126

LOT 160 605/2127

LOT 161 605/2128

LOT 162 605/2129

LOT 163 605/2130

LOT 164 605/2131

LOT 165 605/2132

LOT 166 605/2133

LOT 167 605/2134

LOT 168 605/2135

LOT 169 605/2136

LOT 170 605/2137

LOT 171 605/2138

LOT 172 605/2139

LOT 173 605/2140

LOT 174 605/2141

LOT 175 605/2142

LOT 176 605/2143

LOT 177 605/2144

LOT 178 605/2145

LOT 179 605/2146

LOT 180 605/2147

LOT 181 605/2148

LOT 182 605/2149

LOT 183 605/2150

LOT 184 605/2151

LOT 185 605/2152

LOT 186 605/2153

LOT 187 605/2154

LOT 188 605/2155

LOT 189 605/2156

LOT 190 605/2157

LOT 191 605/2158

LOT 192 605/2159

LOT 193 605/2160

LOT 194 605/2161

LOT 195 605/2162

LOT 196 605/2163

LOT 197 605/2164

LOT 198 605/2165

LOT 199 605/2166

LOT 200 605/2167

LOT 201 605/2168

LOT 202 605/2169

LOT 203 605/2170

LOT 204 605/2171

LOT 205 605/2172

LOT 206 605/2173

LOT 207 605/2174

LOT 208 605/2175

LOT 209 605/2176

LOT 210 605/2177

LOT 211 605/2178

LOT 212 605/2179

LOT 213 605/2180

LOT 214 605/2181

LOT 215 605/2182

LOT 216 605/2183

LOT 217 605/2184

LOT 218 605/2185

LOT 219 605/2186

LOT 220 605/2187

LOT 221 605/2188

LOT 222 605/2189

LOT 223 605/2190

LOT 224 605/2191

LOT 225 605/2192

LOT 226 605/2193

LOT 227 605/2194

LOT 228 605/2195

LOT 229 605/2196

LOT 230 605/2197

LOT 231 605/2198

LOT 232 605/2199

LOT 233 605/2200

LOT 234 605/2201

LOT 235 605/2202

LOT 236 605/2203

LOT 237 605/2204

LOT 238 605/2205

LOT 239 605/2206

LOT 240 605/2207

LOT 241 605/2208

LOT 242 605/2209

LOT 243 605/2210

LOT 244 605/2211

LOT 245 605/2212

LOT 246 605/2213

LOT 247 605/2214

LOT 248 605/2215

LOT 249 605/2216

LOT 250 605/2217

LOT 251 605/2218

LOT 252 605/2219

LOT 253 605/2220

LOT 254 605/2221

LOT 255 605/2222

LOT 256 605/2223

LOT 257 605/2224

LOT 258 605/2225

LOT 259 605/2226

LOT 260 605/2227

LOT 261 605/2228

LOT 262 605/2229

LOT 263 605/2230

LOT 264 605/2231

LOT 265 605/2232

LOT 266 605/2233

LOT 267 605/2234

LOT 268 605/2235

LOT 269 605/2236

LOT 270 605/2237

LOT 271 605/2238

LOT 272 605/2239

LOT 273 605/2240

LOT 274 605/2241

LOT 275 605/2242

LOT 276 605/2243

LOT 277 605/2244

LOT 278 605/2245

LOT 279 605/2246

LOT 280 605/2247

LOT 281 605/2248

LOT 282 605/2249

LOT 283 605/2250

LOT 284 605/2251

LOT 285 605/2252

LOT 286 605/2253

LOT 287 605/2254

LOT 288 605/2255

LOT 289 605/2256

LOT 290 605/2257

LOT 291 605/2258

LOT 292 605/2259

LOT 293 605/2260

LOT 294 605/2261

LOT 295 605/2262

LOT 296 605/2263

LOT 297 605/2264

LOT 298 605/2265

LOT 299 605/2266

LOT 300 605/2267

LOT 301 605/2268

LOT 302 605/2269

LOT 303 605/2270

LOT 304 605/2271

LOT 305 605/2272

LOT 306 605/2273

LOT 307 605/2274

LOT 308 605/2275

LOT 309 605/2276

LOT 310 605/2277

LOT 311 605/2278

LOT 312 605/2279

LOT 313 605/2280

LOT 314 605/2281

LOT 315 605/2282

LOT 316 605/2283

LOT 317 605/2284

LOT 318 605/2285

LOT 319 605/2286

LOT 320 605/2287

LOT 321 605/2288

LOT 322 605/2289

LOT 323 605/2290

LOT 324 605/2291

LOT 325 605/2292

LOT 326 605/2293

LOT 327 605/2294

LOT 328 605/2295

LOT 329 605/2296

LOT 330 605/2297

LOT 331 605/2298

LOT 332 605/2299

LOT 333 605/2300

LOT 334 605/2301

LOT 335 605/2302

LOT 336 605/2303

LOT 337 605/2304

LOT 338 605/2305

LOT 339 605/2306

LOT 340 605/2307

LOT 341 605/2308

LOT 342 605/2309

LOT 343 605/2310

LOT 344 605/2311

LOT 345 605/2312

LOT 346 605/2313

LOT 347 605/2314

LOT 348 605/2315

LOT 349 605/2316

LOT 350 605/2317

LOT 351 605/2318

LOT 352 605/2319

LOT 353 605/2320

LOT 354 605/2321

LOT 355 605/2322

LOT 356 605/2323

LOT 357 605/2324

LOT 358 605/2325

LOT 359 605/2326

LOT 360 605/2327

LOT 361 605/2328

LOT 362 605/2329

LOT 363 605/2330

LOT 364 605/2331

LOT 365 605/2332

LOT 366 605/2333

LOT 367 605/2334

LOT 368 605/2335

LOT 369 605/2336

LOT 370 605/2337

LOT 371 605/2338

LOT 372 605/2339

LOT 373 605/2340

LOT 374 605/2341

LOT 375 605/2342

LOT 376 605/2343

LOT 377 605/2344

LOT 378 605/2345

LOT 379 605/2346

LOT 380 605/2347

LOT 381 605/2348

LOT 382 605/2349

LOT 383 605/2350

LOT 384 605/2351

LOT 385 605/2352

LOT 386 605/2353

LOT 387 605/2354

LOT 388 605/2355

LOT 389 605/2356

LOT 390 605/2357

LOT 391 605/2358

LOT 392 605/2359

LOT 393 605/2360

LOT 394 605/2361

LOT 395 605/2362

LOT 396 605/2363

LOT 397 605/2364

LOT 398 605/2365

LOT 399 605/2366

LOT 400 605/2367

LOT 401 605/2368

LOT 402 605/2369

LOT 403 605/2370

LOT 404 605/2371

LOT 405 605/2372

LOT 406 605/2373

LOT 407 605/2374

LOT 408 605/2375

LOT 409 605/2376

LOT 410 605/2377

LOT 411 605/2378

LOT 412 605/2379

LOT 413 605/2380

LOT 414 605/2381

LOT 415 605/2382

LOT 416 605/2383

LOT 417 605/2384

LOT 418 605/2385

LOT 419 605/2386

LOT 420 605/2387

LOT 421 605/2388

LOT 422 605/2389

LOT 423 605/2390

LOT 424 605/2391

LOT 425 605/2392

LOT 426 605/2393

LOT 427 605/2394

LOT 428 605/2395

LOT 429 605/2396

LOT 430 605/2397

LOT 431 605/2398

LOT 432 605/2399

LOT 433 605/2400

LOT 434 605/2401

LOT 435 605/2402

LOT 436 605/2403

LOT 437 605/2404

LOT 438 605/2405

LOT 439 605/2406

LOT 440 605/2407

LOT 441 605/2408

LOT 442 605/2409

LOT 443 605/2410

LOT 444 605/2411

LOT 445 605/2412

LOT 446 605/2413

LOT 447 605/2414

LOT 448 605/2415

LOT 449 605/2416

LOT 450 605/2417

LOT 451 605/2418

LOT 452 605/2419

LOT 453 605/2420

LOT 454 605/2421

LOT 455 605/2422

LOT 456 605/2423

LOT 457 605/2424

LOT 458 605/2425

LOT 459 605/2426

LOT 460 605/2427

LOT 461 605/2428

LOT 462 605/2429

LOT 463 605/2430

LOT 464 605/2431

LOT 465 605/2432

LOT 466 605/2433

LOT 467 605/2434

LOT 468 605/2435

LOT 469 605/2436

LOT 470 605/2437

LOT 471 605/2438

LOT 472 605/2439

LOT 473 605/2440

LOT 474 605/2441

LOT 475 605/2442

LOT 476 605/2443

LOT 477 605/2444

LOT 478 605/2445

LOT 479 605/2446

LOT 480 605/2447

LOT 481 605/2448

LOT 482 605/2449

LOT 483 605/2450

LOT 484 605/2451

LOT 485 605/2452

LOT 486 605/2453

LOT 487 605/2454

LOT 488 605/2455

LOT 489 605/2456

LOT 490 605/2457

LOT 491 605/2458

LOT 492 605/2459

LOT 493 605/2460

LOT 494 605/2461

LOT 495 605/2462

LOT 496 605/2463

LOT 497 605/2464

LOT 498 605/2465

LOT 499 605/2466

LOT 500 605/2467

LOT 501 605/2468

LOT 502 605/2469

LOT 503 605/2470

LOT 504 605/2471

LOT 505 605/2472

LOT 506 605/2473

LOT 507 605/2474

LOT 508 605/2475

LOT 509 605/2476

LOT 510 605/2477

LOT 511 605/2478

LOT 512 605/2479

LOT 513 605/2480

LOT 514 605/2481

LOT 515 605/2482

LOT 516 605/2483

LOT 517 605/2484

LOT 518 605/2485

LOT 519 605/2486

LOT 520 605/2487

LOT 521 605/2488

LOT 522 605/2489

LOT 523 605/2490

LOT 524 605/2491

LOT 525 605/2492

LOT 526 605/2493

LOT 527 605/2494

LOT 528 605/2495

LOT 529 605/2496

LOT 530 605/2497

LOT 531 605/2498

LOT 532 605/2499

LOT 533 605/2500

LOT 534 605/2501

LOT 535 605/2502

LOT 536 605/2503

LOT 537 605/2504

LOT 538 605/2505

LOT 539 605/2506

LOT 540 605/2507

LOT 541 605/2508

LOT 542 605/2509

LOT 543 605/2510

LOT 544 605/2511

LOT 545 605/2512

LOT 546 605/2513

LOT 547 605/2514

LOT 548 605/2515

LOT 549 605/2516

LOT 550 605/2517

LOT 551 605/2518

LOT 552 605/2519

LOT 553 605/2520

LOT 554 605/2521

LOT 555 605/2522

LOT 556 605/2523

LOT 557 605/2524

LOT 558 605/2525

LOT 559 605/2526

LOT 560 605/2527

LOT 561 605/2528

LOT 562 605/2529

LOT 563 605/2530

LOT 564 605/2531

LOT 565 605/2532

LOT 566 605/2533

LOT 567 605/2534

LOT 568 605/2535

LOT 569 605/2536

LOT 570 605/2537

LOT 571 605/2538

LOT 572 605/2539

LOT 573 605/2540

LOT 574 605/2541

LOT 575 605/2542

LOT 576 605/2543

LOT 577 605/2544

LOT 578 605/2545

LOT 579 605/2546

LOT 580 605/2547

LOT 581 605/2548

LOT 582 605/2549

LOT 583 605/2550

LOT 584 605/2551

LOT 585 605/2552

LOT 586 605/2553

LOT 587 605/2554

LOT 588 605/2555

LOT 589 605/2556

LOT 590 605/2557

LOT 591 605/2558

LOT 592 605/2559

LOT 593 605/2560

LOT 594 605/2561

LOT 595 605/2562

LOT 596 605/2563

LOT 597 605/2564

LOT 598 605/2565

LOT 599 605/2566

LOT 600 605/